

Plugg for påmontering

Bestillingsnr. 391



- Skrukontakt

Tekniske spesifikasjoner

| | |
|-----------------|---------------|
| Ampere | 32 A |
| Poler | 5 p |
| Volt | 400 V |
| Klokkeposisjon | 6 h |
| Hertz | 50-60 Hz |
| Tilkoblingsmåte | skrukontakt |
| Kontakt | standard |
| Kapslingsgrad | IP44 |
| Vekt | 260 g |
| Kontrollmerke | VDE, EAC, CQC |

Dimensjoner

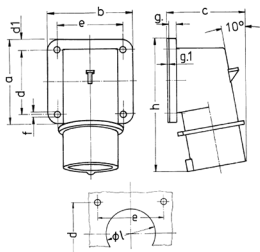

| Drawing 2 MB 73 | Amp. Poles | 16 | | 32 | | |
|---------------------------------------------------------------|---------------|------|------|-----|-----|-----|
| | | 4 | 5 | 3 | 4 | 5 |
| Dim. in mm | a | 85 | 85 | 75 | 75 | 75 |
| | b | 85 | 85 | 90 | 90 | 90 |
| | c | 75 | 79 | 87 | 87 | 90 |
| | d | 64 | 64 | 45 | 45 | 45 |
| | d1 | 10 | 10 | 13 | 13 | 13 |
| | e | 64 | 64 | 78 | 78 | 78 |
| | f | 5.5 | 5.5 | 5.5 | 5.5 | 5.5 |
| | g | 6 | 6 | 6 | 6 | 6 |
| | g-1 | 2 | 2 | 2 | 2 | 2 |
| | h | 129 | 129 | 137 | 137 | 138 |
| | l | 50 | 50 | 55 | 55 | 55 |
| Terminal for cond. cross section (mm ²) min.-max. | | 1 | 1 | 2.5 | 2.5 | 2.5 |
| | | -2.5 | -2.5 | -6 | -6 | -6 |